



# HF-Selectalume II for TL5 lamps

## HF-S 124/39 TL5 II 220-240V 50/60Hz

HF-Selectalume II TL5 is the most cost-effective, reliable and outstanding solution for fluorescent lamps. These ballasts are part of an overall high-efficiency lighting system that may help you or your customers to achieve any international or local energy code you need to comply with. HF-Selectalume II TL5 ballasts are the ideal choice for a broad range of new construction and retrofit applications within the commercial sector, including general surface mounting or office lighting, parking garages, warehouses, waterproof and other applications.

### Product data

| General Information             |                   | Ballast Factor (Nom)                           |  |
|---------------------------------|-------------------|--|--|
| Application Code                | II                |  | 1.05   |
| Type Version                    | mk1               | Power Losses (Nom)                             | 3.5/4 W  |
| Lamp Type                       | TL5               | Inrush Current Peak (Max)                      | 20 A   |
| Number of Lamps                 | 1 piece/unit      | <b>Wiring</b>                                  |  |
| Automatic Restart               | Yes               | Connector Type Input Terminals                 | WAGO 744 connector   |
| <b>Operating and Electrical</b> |                   | Cable Capacity Output Wires Mutual (Max)       | 200 pF   |
| Input Voltage                   | 220 to 240 V      | Connector Type Output Terminals                | WAGO 744 connector [ Suitable for manual wiring]                       |
| Input Frequency                 | 50 to 60 Hz       | Cable Length Hot Wiring                        | 0.75 m   |
| Operating Frequency (Nom)       | 45 kHz            | Wire Striplength                               | 8.0-9.0 mm   |
| Crestfactor (Nom)               | 1.7               | Dual Fixture Master/Slave                      | Possible, lamp wires 2m max. length [ Master/Slave operation possible] |
| Power Factor 100% Load (Nom)    | 0.98              | Input Terminal Cross Section                   | 0.50-1.50 mm <sup>2</sup>  |
| Preheat Time                    | 1.6 s             | Output Terminal Cross Section                  | 0.50-1.50 mm <sup>2</sup>  |
| Mains Voltage Performance (AC)  | 202-254V-8%-+6%   | Cable Capacity Cold Output Wires - Earth (Max) | 200 pF   |
| Mains Voltage Safety (AC)       | 198-264V-10%-+10% |  |  |
| Earth Leakage Current (Max)     | 0.5 mA            |  |  |
| Inrush Current Width            | 0.28 ms           |  |  |

## HF-Selectalume II for TL5 lamps

|   |        |
|---|--------|
| Cable Capacity Hot Output Wires - Earth (Max) | 200 pF |
|---|--------|

### System characteristics

|                          |           |
|--------------------------|-----------|
| Rated Ballast-Lamp Power | 24/39 W   |
| Rated Lamp Power on TL5  | 24/39 W   |
| System Power on TL5      | 27/42 W   |
| Lamp Power on TL5        | 23.5/38 W |
| Power Loss on TL5        | 3.5/4 W   |

### Temperature

|                       |        |
|-----------------------|--------|
| T-Ambient (Max)       | 50 °C  |
| T-Ambient (Min)       | -15 °C |
| T-Storage (Max)       | 80 °C  |
| T-Storage (Min)       | -40 °C |
| T-Case Lifetime (Nom) | 75 °C  |
| T-Case Maximum (Max)  | 75 °C  |

### Mechanical and Housing

|         |               |
|---------|---------------|
| Housing | L 280x30x21.5 |
|---------|---------------|

### Emergency Operation

|   |              |
|---|--------------|
| Nominal Light Output After 60 Seconds       | 100% of EBLF |
| Normal Operating Voltage (DC)               | 220-240 V    |
| Battery Voltage Guaranteed Operation        | 176-275 V    |
| Battery Voltage Guaranteed Ignition         | 186-275 V    |
| Emergency Ballast Lumen Factor (EBLF) (Nom) | 100 %        |

## Dimensional drawing

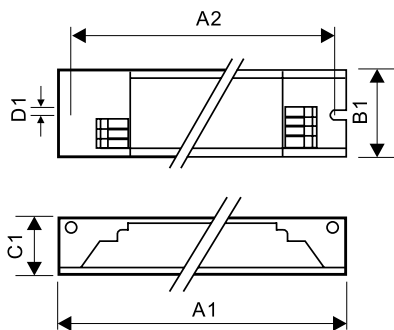

HF-S 124-39 TL5 II 220-240V 50/60Hz

|                                      |             |
|--------------------------------------|-------------|
| Nominal Light Output After 5 Seconds | 50% of EBLF |
|--------------------------------------|-------------|

### Approval and Application

|                         |   |
|-------------------------|---|
| Energy Efficiency Index | A2/A2BAT  |
| IP Classification       | IP 20 [ Ingress Protection 20]  |
| EMI 9 kHz ... 30 MHz    | EN55015   |
| Vibration Standard      | IEC68-2-6 F c   |
| Bumps Standard          | IEC 68-2-29 Eb (10G/16ms)   |
| Approval Marks          | F-Marking CE marking ENEC certificate<br>CCC certificate C-Tick certificate PSB<br>certification TISI marking SIRIM approval<br>CB Certificate CCC certificate VDE-EMV<br>certificate |
| Hum And Noise Level     | < 30 dB(A)  |

### Product Data

|                                 |                                     |
|---------------------------------|-------------------------------------|
| Full product code               | 872790093933000                     |
| Order product name              | HF-S 124-39 TL5 II 220-240V 50/60Hz |
| EAN/UPC - Product               | 8727900939330                       |
| Order code                      | 93933000                            |
| Numerator - Quantity Per Pack   | 1                                   |
| Numerator - Packs per outer box | 12                                  |
| Material Nr. (12NC)             | 913713034466                        |
| Net Weight (Piece)              | 0.190 kg                            |

### Product

HF-S 124-39 TL5 II 220-240V 50/60Hz

## HF-Selectalume II for TL5 lamps

